

C-93-162

Pg. 183

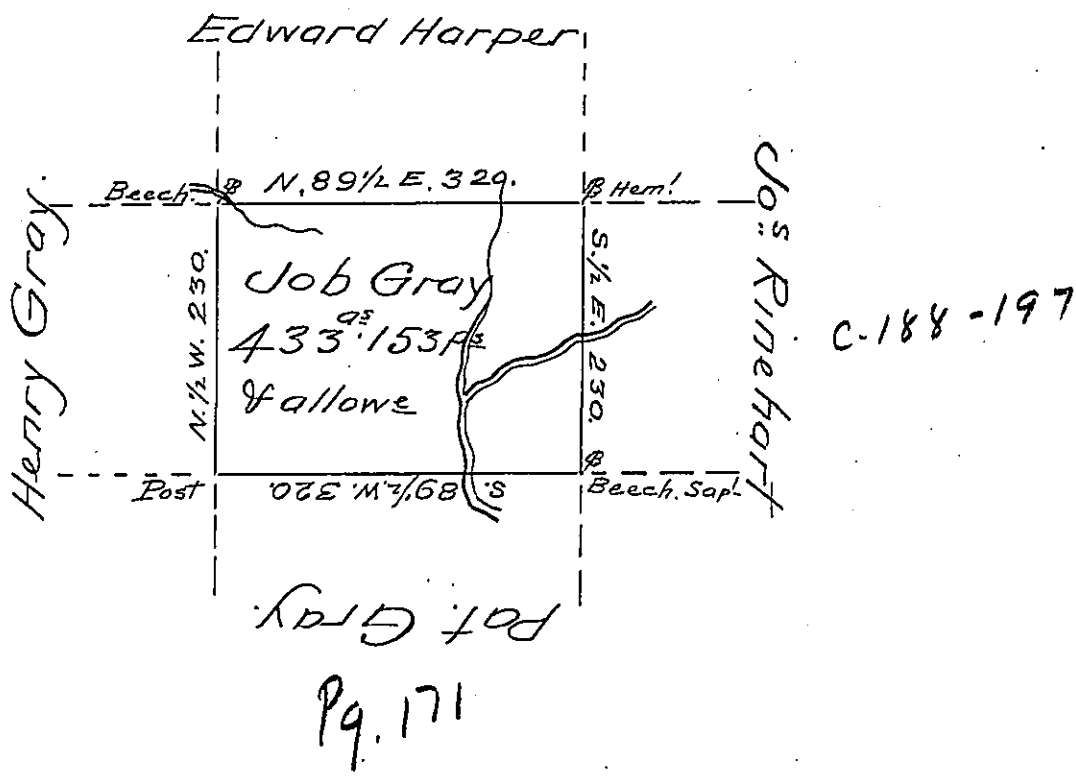

A Draught of a tract of land called _____
 Situate in the County of Luzerne Adjoining Henry
 Gray & others Surveyed the 16th day of Novem^r
 1792 for Job Gray in pursuance of a warrant
 bearing date the 3^d day of April 1792 Con-
 taining Four hundred thirty three Acres & one
 hundred & fifty three perch^s & the usual allow-
 ance of Six P^r Cent for roads &c.

To Dan^l Brodhead Esq^r } Ant^y Crothers D.S.
 Surveyor General }

IN TESTIMONY that the above is a copy of the original remaining on file in
 the Department of Internal Affairs of Pennsylvania, made
 conformably to an Act of Assembly approved the 16th day of
 February, 1833, I have hereunto set my Hand and caused
 the Seal of said Department to be affixed at Harrisburg,
 this Twenty fifth day of October 1904.

Joseph P. Brown
 Secretary of Internal Affairs.